

HORIBA

Water Distribution
Monitor

TW-100

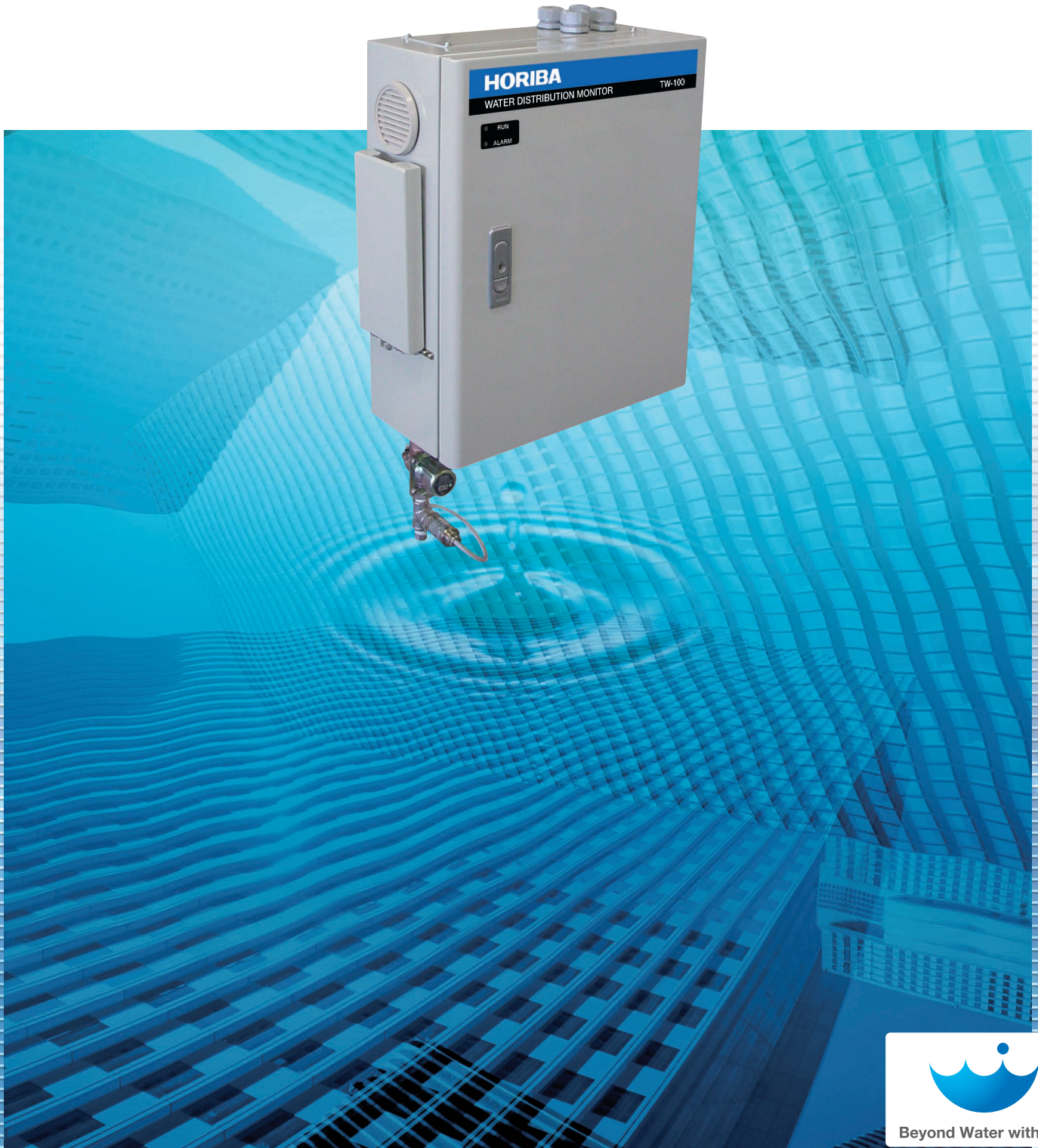

Beyond Water with You

Explore the future

Automotive | Process & Environmental | Medical | Semiconductor | Scientific

HORIBA



Water Distribution Monitor

TW-100

HORIBA's TW-100 is a process water quality measurement system designed for drinking water and water distribution plants. The TW-100 monitors turbidity, color, free chlorine and pressure. This chemical free method reduces operating costs as it requires minimal maintenance and improves process control.

This compact system is equipped with sensors to monitor four water quality parameters. Optional sensors can be added to monitor as many as seven water quality parameters. No reagents are required for the measurement.

Standard Four parameters:
Turbidity, color, free chlorine, water pressure

Optional Seven parameters:
Turbidity, color, free chlorine, water pressure, pH, electric conductivity, water temperature



The instrument is operated with a touch screen panel for easy operation and display of measured values.

- Operation panel specifications
320x240 dots
Black and white graphic LCD with backlight

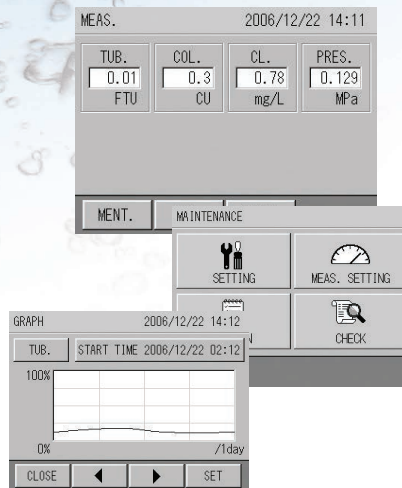

The compact size allows for more installation location options and space for operation.

Features:

- Automatic cleaning
- Adjustable measurement frequency
- Variable sample volume
- Automatic zero calibration
- Internal water leak detection and alarm
- Data storage to compact flash card

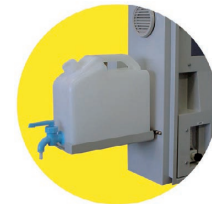

Reagent bottle tray for calibration (standard)

[Chart 1]

Standard type

Parameters	Method	Range	Repeatability	Calibration method
Turbidity	Transmitted light absorption	0 to 2 FTU, 0 to 4 FTU	Full scale $\pm 2.5\%$	Formazin standard solution or polystyrene latex standard solution
Color	Transmitted light absorption	0 to 10 CU, 0 to 20 CU	Full scale $\pm 5.0\%$	Standard color solution
Free chlorine	Polarography	0 to 2 mg/L	Full scale $\pm 2.5\%$	DPD colorimetry
Water pressure	Diaphragm pressure sensor	0 to 1 MPa	Full scale $\pm 1.0\%$	Standard pressure gauge

Option (each parameter can be added to the standard type)

Parameters	Method	Range	Repeatability	Calibration method
pH	Glass electrode	pH 2 to 12	± 0.1 pH	pH 7 and pH 9 standard solutions
Conductivity	AC bipole	0 to 50 mS/m	Full scale $\pm 2.0\%$	KCL standard solution
Water temperature	Thermistor	0 to 50°C	$\pm 0.5^\circ\text{C}$	Standard thermometer

System specifications

Product name	Water Distribution Monitor
Model name	TW-100
Parameters	Turbidity, color, free chlorine, water pressure (standard); pH, conductivity, water temperature (option)
Methods	See chart 1.
Range	See chart 1.
Repeatability	See chart 1.
Display	LCD display: 320 x 240 dot B&W graphic LCD with backlight (touch panel type) Standard version simultaneously displays four measurement categories (turbidity, color, free chlorine, and water pressure); Optional version simultaneously displays up to seven parameters (the four parameters plus pH, conductivity, and water temperature)
Calibration method	See chart 1.
Automatic zero calibration	(Turbidity, color, free chlorine) Calibration method: Measurement of filtered sample water Trigger: Internal control (timer) or external control. Interval: 1 to 9999 hours (can be set as desired within that range) Time: 20 to 99 minutes (can be set as desired within that range)
Automatic cleaning	(Turbidity, color) Cleaning method: Wiper cleaning Trigger: Internal control (timer) or external control. Interval: 5 to 9999 hours (can be set as desired within that range) (Free chlorine) Continuous cleaning with beads grinder
Sample water conditions	Temperature: 0 to 40C (must not freeze) Pressure: 0.1 to 0.75 MPa Flow rate: over 100 mL/min Flow rate for measurement: 50 to 100 mL/min * Be sure to flush the sample water before starting the system. * Be sure to install a bypass for the pipe to which the system is attached. * If there is any possibility that the sample water could freeze, please protect the system from cold temperature.
Ambient temperature/humidity	Temperature; 0 to 40C; Humidity: 85% or less
Analog output	Type: Measurement value: Same number as parameters (4 standard, 7 as maximum) Specifications: DC 4 to 20 mA, insulated output (no insulation between parameters), maximum load resistance 600 Ω
Output signal	Type: Power off, batch alerts, maintenance Details: Power off: Output when power is off. Batch alerts: Cell temperature error, compensation temperature error, cell wiper error, internal communication error, water leak, battery error, upper and lower limit of measurement, light source error, zero calibration, span calibration, analyzer error Maintenance: Output when the system is in maintenance or calibration mode. Specifications: Non-voltage contact output, a contacts Contact ratings: AC 125 V, 0.3 A, DC 30 V, 1 A (depends on resistance load), each output COM is independent.
Input signal	Type: Cleaning start, zero calibration start, error check sequence start, error water sampling start Details: Cleaning start: Cleaning procedure initiated with closed contact input Zero calibration start: Zero calibration initiated with closed contact input Error discrimination start: Error discrimination initiated with closed contact input Error water sample sampling start: Error water sample sampling initiated with closed contact input Specifications: Non-voltage contact input (open collector contact can be used), insulated input Resistance when ON: Maximum 100 W; Open voltage: DC 26 V; Short-circuit current: Max. 13 mA
Communications	Interface: RS-232C compliant (*Remote monitoring system is option)
Functions	Estimation of sample water volume (counting type), internal water leak detection, error water sampling
Data memory	Measurement values for each parameters are stored in the unit's data memory. Data can be transferred to a CF card. Memory interval: 1 minute or 1 hour Memory schedule: At the top of the hour Data memory longevity: 1 minute intervals: About 10 days; 1 hour intervals: About 1 year. * The latest data is written to update a series of data.
Wiring contact	Wiring ground: For power source: φ8.5~φ10.5; For input/output: φ12.5~φ14.5
Piping contact	Sample water input: Rc 1/4; Drainage: Rc 1/4; Calibration solution input: Rc 1/8; Error sample sampling aperture: Rc 1/8
Construction	Designed for indoor installation. * Housed in a special case (frame) for exterior installation (option).
Power	AC 100 V to AC 230 V, 10%, 50/60 Hz
Power consumption	AC 100 V to AC 120 V: 120 VA; AC 100 V to AC 230 V: 150 VA
Weight	Approx. 15 kg (Measurement unit only)
External dimensions	350 mm (W) x 160 mm (D) x 420 mm (H) (not including installation fixtures and projecting portions)
Paint color/Material	Munsell 5PB8/1; Unit case is made of SUS.
Installation environment	<ul style="list-style-type: none"> • Install on a flat surface without vibration shocks. • No dust, mist, or corrosive gases in the atmosphere. •Lower air pressure. •No direct sunlight. • Ventilated air. •2,000 m or less above sea level.

■ Exterior dimensions (unit: mm)

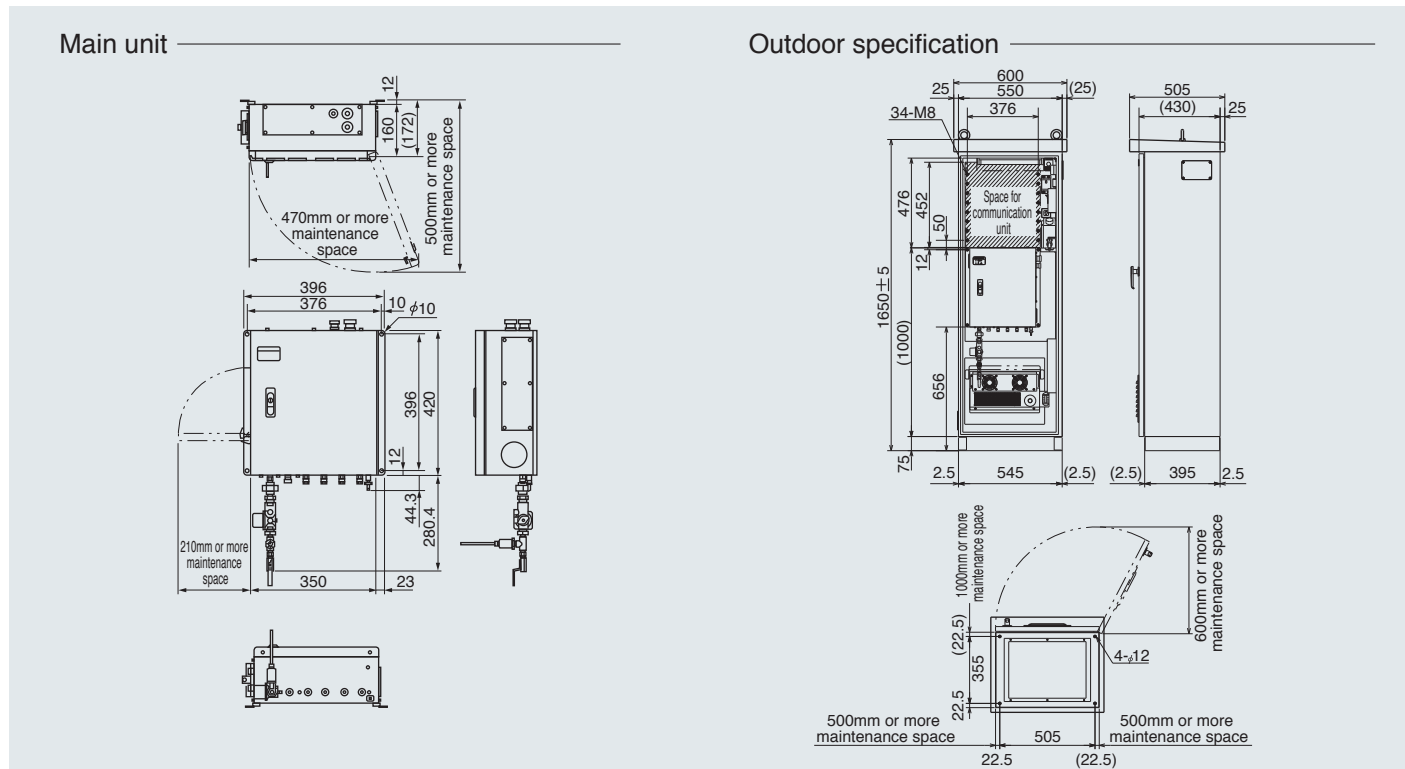

The HORIBA Group adopts IMS (Integrated Management System) which integrates Quality Management System ISO9001, Environmental Management System ISO14001, and Occupational Health and Safety Management System ISO45001. We have now integrated Business Continuity Management System ISO22301 in order to provide our products and services in a stable manner, even in emergencies.



Please read the operation manual before using this product to assure safe and proper handling of the product.

●The specifications, appearance or other aspects of products in this catalog are subject to change without notice. ●Please contact us with enquiries concerning further details on the products in this catalog. ●The color of the actual products may differ from the color pictured in this catalog due to printing limitations. ●It is strictly forbidden to copy the content of this catalog in part or in full. ●The screen displays shown on products in this catalog have been inserted into the photographs through compositing. ●All brand names, product names and service names in this catalog are trademarks or registered trademarks of their respective companies.

<p>HORIBA Advanced Techno, Co., Ltd. Japan Head Office 2 Miyano Higashi-cho, Kisshoin, Minami-ku, Kyoto, 601-8551, Japan Phone: 81 (75) 321-7184 Fax: 81 (75) 321-7291 www.horiba.com/water-liquid/</p>	<p>HORIBA Vietnam Company Limited. Vietnam Lot 3 and 4, 16 Floor, Detech Tower II, No. 107 Nguyen Phong Sac Street, Dich Vong Hau Ward, Cau Giay District, Hanoi, Vietnam Phone: 84 (24) 3795 8552 Fax: 84 (24) 3795 8553</p> <p>Ho Chi Minh Branch Office Level 7, Saigon Finance Center, 9 Dinh Tien Hoang, DaKao Ward, District 1, Ho Chi Minh City, Viet Nam Phone: +84-28-3829-9636 Fax: +84-28-3827-3068</p>	<p>HORIBA Instruments Incorporated USA Houston Office 5390 Bay Oaks Drive, Pasadena, TX 77505 Phone: 1 (281) 482-4334 Fax: 1 (281) 674-6058</p>
<p>HORIBA (China) Trading Co., Ltd. China Unit D, 1F, Building A, Synnex International Park, 1068 West Tianshan Road, 200335, Shanghai, China Phone: 86 (21) 6289-6060 Fax: 86 (21) 6289-5553</p> <p>Beijing Branch 12F, Metropolis Tower, No.2, Haidian Dong 3 Street, Beijing, 100080, China Phone: 86 (10) 8567-9966 Fax: 86 (10) 8567-9066</p> <p>Guangzhou Branch Room 1611/1612, Goldinn Digital Network Center, 138 Tiyu Road East, Guangzhou, 510620, China Phone: 86 (20) 3878 1883 Fax: 86 (20) 3878 1810</p>	<p>PT HORIBA Indonesia Indonesia Jl. Jalur Sutera Blok 20A, No.16-17, Kel. Kunciran, Kec. Pinang Tangerang-15144, Indonesia Phone: 62 (21) 3044-8525 Fax: 62 (21) 3044-8521</p>	<p>HORIBA Instruments Brasil, Ltda. Brazil Rua Presbitero Plinio Alves de Souza, 645, Loteamento Multivias, Jardim Ermida II - Jundiá Sao Paulo - CEP 13.212-181 Brazil Phone: 55 (11) 2923-5400 Fax: 55 (11) 2923-5490</p>
<p>HORIBA (Thailand) Limited Thailand 46/8 Rungrojthanakul Bld., 1st, 2nd Floor, Ratchadapisek Road., Huai Khwang Bangkok 10310 Phone: +66 (0) 2 861 59 95 ext.123 Fax: +66 (0) 2 861 52 00</p>	<p>HORIBA KOREA Ltd. Korea 25, 94-Gil, Iljik-Ro, Manan-Gu, Anyang-Si, Gyeonggi-Do, 13901, Korea Phone: 82 (31) 296-7911 Fax: 82 (31) 296-7913</p>	<p>HORIBA Europe Research Center France 14, Boulevard Thomas Gobert - Passage Jobin Yvon CS 45002-91120 Palaiseau-France Phone: 33 (1) 69-74-72-00 Fax: 33 (1) 69-31-32-20</p>
<p>HORIBA Instruments (Singapore) Pte Ltd. Singapore 3 Changi Business Park Vista #01-01, Singapore 486051 Phone: 65 (6) 745-8300 Fax: 65 (6) 745-8155</p> <p>West Office 83 Science Park Drive, #02-02A, The Curie, Singapore 118258 Phone: (65)-6-908-9660</p>	<p>HORIBA Taiwan, Inc. Taiwan 8F.-8, No.38, Taiyuan St., Zhubei City, Hsinchu County, 30265, Taiwan (R.O.C) Phone: 886 (3) 560 0606 Fax: 886 (3) 560 0550</p> <p>Tainan Office 1F., No.90 Ziyou Rd., Shanhuia Dist., Tainan City, 74158, Taiwan (R.O.C) Phone: (886)6-581-1108 Fax: (886)6-581-1160</p>	<p>HORIBA UK Limited UK Kyoto Close Moulton Park, Northampton NN3 6FL, UK Phone: 44 (0) 1604 542 500 Fax: 44 (0) 1604 542 699</p>
<p>HORIBA Instruments (Singapore) Pte Ltd. Philippines Manila Office 27/F Tower 2, The Enterprise Center, 6766 Ayala Avenue corner Paseo de Roxas, Brgy. San Lorenzo, Makati City, Philippines, 1226 Phone: 63 (2) 8885 8468</p>	<p>HORIBA India Private Limited India 246, Okhla Industrial Estate, Phase 3 New Delhi-110020, India Phone: 91 (11) 4646-5000 Fax: 91 (11) 4646-5020 Email: customer-care-pe.hin@horiba.com</p> <p>Technical Center D-255, Chakan MIDC Phase-II, Bhamboli Village, Pune-410501, India Phone: 91 (21) 3567-6000</p> <p>Bangalore Office 3rd, No.504, 22nd Cross HSR Club Road Sector-3, Bengaluru, Karnataka, 560102, INDIA Phone: 91 (80) 4127-3637</p>	<p>HORIBA Europe GmbH Germany Hans-Mess-Str.6 D-61440 Oberursel Germany Phone: 49 (6172) 1396-0 Fax: 49 (6172) 1373-85</p> <p>HORIBA Tocadero GmbH Germany Johann-Hittorf-Str. 8, 12489 Berlin, Germany Phone: 49 (0)30 6392 3150 Fax: 49 (0)30 6392 3151</p> <p>HORIBA (Austria) GmbH Austria Kaplanstrasse 5, A-3430 Tulln, Austria Phone: 43 (2272) 65225 Fax: 43 (2272) 65225 45</p>



Worldwide locations of HORIBA